

## Vacuum iris diaphragm holder | VIH

NEW

RoHS

Catalog Code

W4152

**Stainless steel iris diaphragm holder can change its aperture size. Uses for optical axis alignment of the laser beam and blocking the return light or stray light.**

- These can be used for UV laser optical system and in the clean room.
- By sliding the adjustment lever, 12 diaphragm blades can be controlled and aperture will have a shape similar to a circular shape. By turning the adjustment lever, the aperture diameter can be fixed.
- The scale for aperture diameter is in the front of the holder.
- Screw hole grooving and vent hole processing are applied to prevent the out-gas emits when forming vacuum.

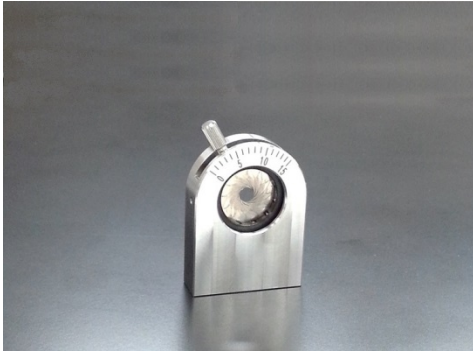

### Guide

- ▶ We deliver the item with specialized vacuum packaging to keep its high clean state from the factory to the destination.
- ▶ We provide vacuum pedestal bases (VPST) and posts (VRO).

▶ WEB Reference Catalog Code W6108, ▶ WEB Reference Catalog Code W6107

### Attention

- ▶ Diaphragm blades of vacuum iris diaphragm holder acts like mirror because of no black anodized. Therefore if laser beam is irradiated, a part of incident light will reflect and return to the optical path.
- ▶ The iris diaphragm is a very delicate mechanism. Pushing or pulling the blades cause malfunction and it cannot be recovered.
- ▶ Heat from high power lasers may deform the blades and cause them to seize.
- ▶ Please open the package in the clean environment. Please do not touch it by your bare hands.

### Outline Drawing

#### VIH-15/22/36

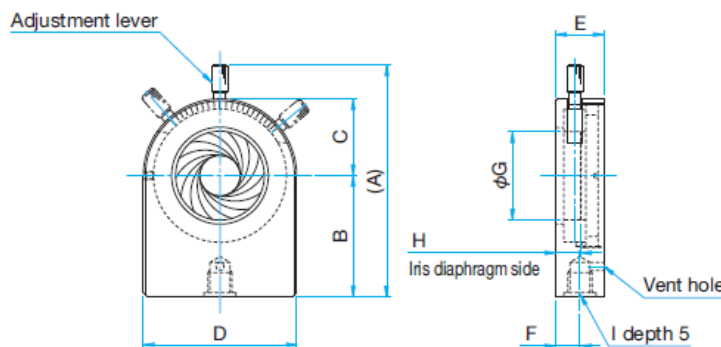

Part Number	A	B	C	D	E	F	G	H	I
VIH-15	43	20	15	30	10	5	15	5.2	M4
VIH-22	57.5	30	19	38	12	5	22	6.2	M6
VIH-36	75	35	30	60	12	6.4	36	6.9	M6

### Specifications

Primary material: Steel  
Finish: None

Part Number	Aperture Diameter		Weight [kg]
	MAX [mm]	MIN [mm]	
VIH-15	φ15	φ0.9	0.06
VIH-22	φ22	φ0.9	0.10
VIH-36	φ36	φ1.3	0.15



**Tokyo Head Office**  
5F, SIGMA KOKI Tokyo Head office 1-19-9,  
Midori, Sumida-ku, Tokyo, 130-0021, JAPAN  
TEL. +81-3-5638-8228  
FAX. +81-3-5638-6550  
E-mail international@sigma-koki.com

**Osaka Branch**  
4-9-28 Nishi-Nakajima,  
Yodogawa-ku, Osaka 532-0011  
TEL. +81-6-6307-4835  
FAX. +81-6-6307-4834  
E-mail sales.osaka@sigma-koki.com

**Kyushu Sales Office**  
3-17 Hie-machi, Hakata-ku, Fukuoka 812-0014  
TEL. +81-92-481-4300  
FAX. +81-92-481-4310  
E-mail sales.kyushu@sigma-koki.com