

High Precision Kinematic Mirror Mounts | **MHM** **NEW** **RoHS** **Catalog Code** W4540

Precision 0.1mm thread pitch fine adjustment screw introduces high resolutions. It is thinner than MHG mounts.

- The C-shaped mounting frame facilitate close-proximity positioning of the optical passes. ◦ The holders are thin which offer more adjustment space compared to the MHG series.
- Mirrors are held at three points along the side to distribute the stress on the mirror evenly.
- The use of retaining rings does not constrain the clear aperture. A large clear aperture can be obtained with reflected or transmitted light.



Guide

- ▶ MHG-NL mirror holders can have locking mechanisms for adjustments screws.
[WEB Reference](#) **Catalog Code** W4001
- ▶ These holders can be mounted on separate post holders or M6 threaded posts.

Attention

- ▶ The threaded hole for posts is offset from the center of the mirror reflective surface. These holders can not be used for installation on an optical bench at 45 degrees incidence. Only mirrors without offset can be used for this application (MHI).

[WEB Reference](#) **Catalog Code** W4102

- ▶ The rotation center for fine adjustment is not along the center of the mirror reflective surface. If fine adjustment is required, please use gimbal mirror holders (MHAN). Gimbal mirror holders have fine adjustments along the center of the mirror reflective surface.

[WEB Reference](#) **Catalog Code** W4010

Specifications						Primary Material: Aluminium Finish: Black Anodized			
Part Number	Compatible Optics		Through hole [mm]	Number of Adjustment Axis	Adjustment Range		Resolution		Weight [kg]
	Diameter [mm]	Thickness [mm]			Tilt [°]	Rotation [°]	Tilt [°/Rotation]	Rotation [°/Rotation]	
MHM-12.7-L	φ 12.7	2.5 - 4	φ 11.5	2	±3	±3	about 0.3	about 0.3	0.011
MHM-12.7-R	φ 12.7	2.5 - 4	φ 11.5	2	±3	±3	about 0.3	about 0.3	0.011
MHM-25.4-L	φ 25, φ 25.4	3 - 5	φ 22.4	2	±3	±3	about 0.15	about 0.15	0.064
MHM-25.4-R	φ 25, φ 25.4	3 - 5	φ 22.4	2	±3	±3	about 0.15	about 0.15	0.064
MHM-30-L	φ 30	3 - 5	φ 27	2	±3	±3	about 0.15	about 0.15	0.064
MHM-30-R	φ 30	3 - 5	φ 27	2	±3	±3	about 0.15	about 0.15	0.064
MHM-50.8-L	φ 50, φ 50.8	5 - 9	φ 47	2	±3	±3	about 0.1	about 0.1	0.104
MHM-50.8-R	φ 50, φ 50.8	5 - 9	φ 47	2	±3	±3	about 0.1	about 0.1	0.104

Outline Drawing

MHM-12.7-L

 Hexagonal socket head cap screw M4×8...1 screws

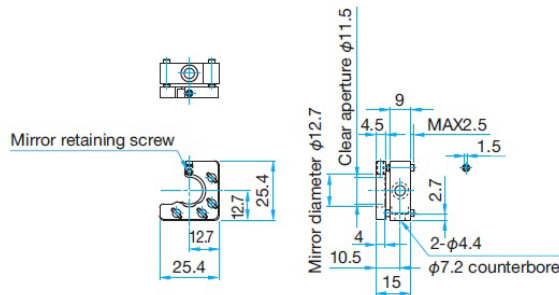

MHM-12.7-R

 Hexagonal socket head cap screw M4×8...1 screws

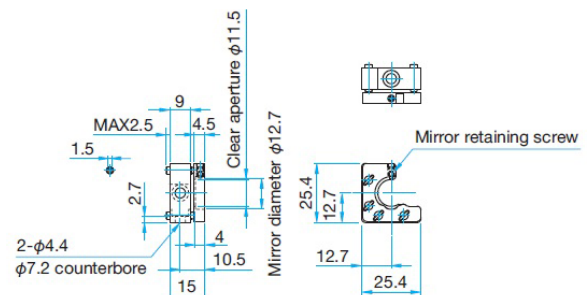

MHM-25.4-L

 Hexagonal socket head cap screw M4×10...1 screws

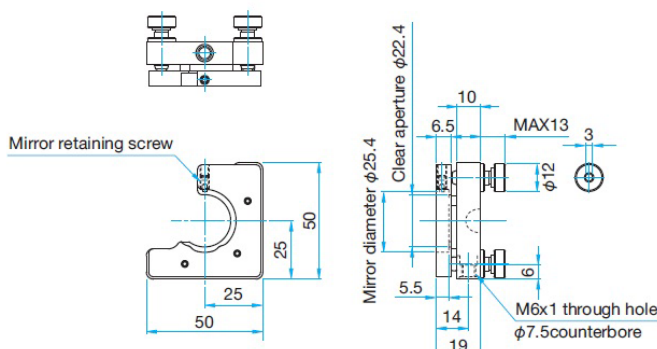

MHM-25.4-R

 Hexagonal socket head cap screw M4×10...1 screws

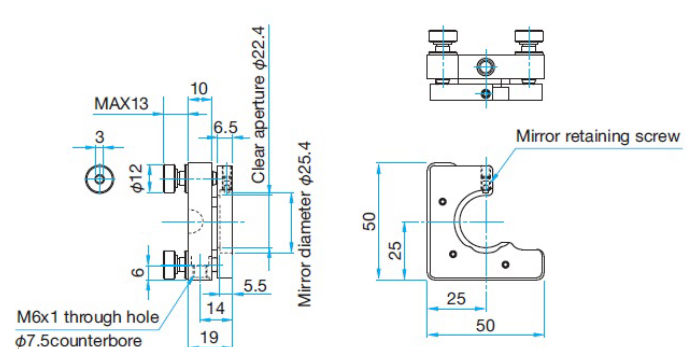

MHM-30-L

 Hexagonal socket head cap screw M4×10...1 screws

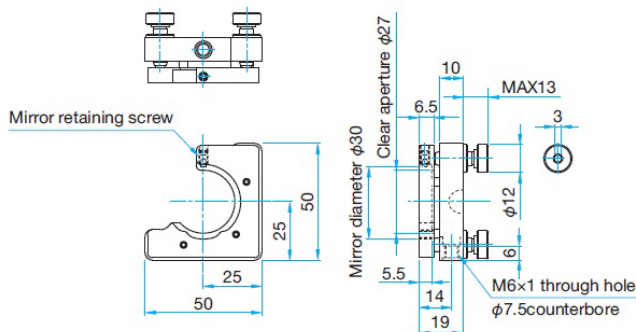

MHM-30-R

 Hexagonal socket head cap screw M4×10...1 screws

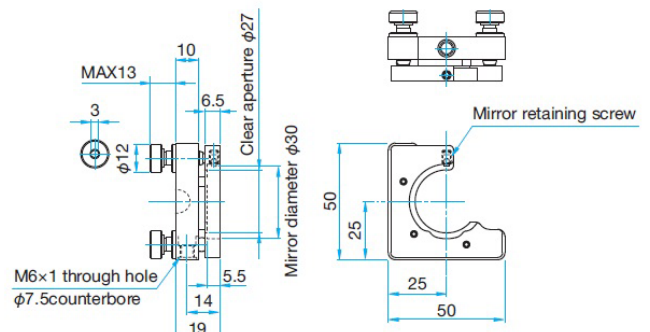

MHM-50.8-L

 Hexagonal socket head cap screw M4×10...1 screws

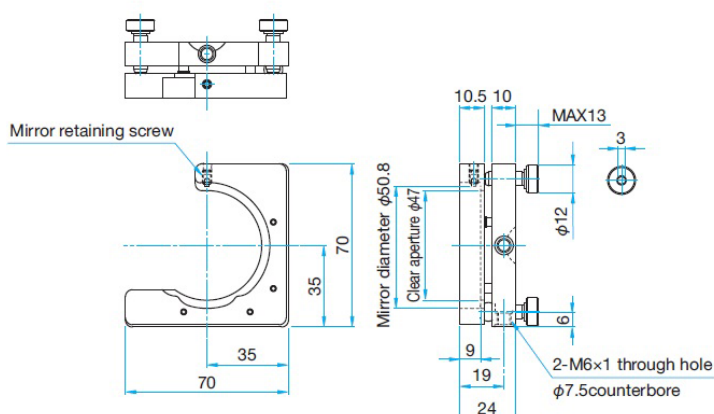

MHM-50.8-R

 Hexagonal socket head cap screw M4×10...1 screws

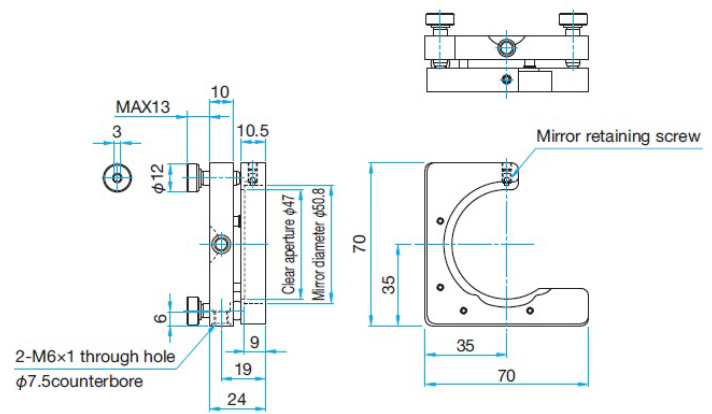

<http://www.global-optosigma.com/>