

Lens case / Filter case | LHGC

NEW **RoHS** **Catalog Code** W4541

Optics, such as filter can be fixed with lens holder by mounting the filter case on the lens holder.

- Filter case can be mounted with or dismantled from lens holder while the lens is mounted on lens holder.
- Mountable diameter of optics is as same as the diameter of the lens holder's compatible optics diameter.
(Except for LHGC-10 and LHGC-15)
- Multiple filter cases can be jointed when the same diameter filter cases (dimension E) are used.
- It allows to use as a filter mount to arrange the combination of the filters.



Guide

- ▶ No resin rings are attached. Please use resin rings (DR) to protect filters from the scratches.
▶ [WEB Reference](#) **Catalog Code** W4017
- ▶ It can be mounted on two axis lens holder (LHCM) or three-axis/five axis lens holder (ALHN) and allows to align a lens to the optical axis.
▶ [WEB Reference](#) **Catalog Code** W4512 , [WEB Reference](#) **Catalog Code** W4016
- ▶ A simple, standalone filter holder (FHS/FH) is also available.
▶ [WEB Reference](#) **Catalog Code** W4043

Attention

- ▶ Filter case may not be mounted on lens holder when the thick lens is fixed on the lens holder.
- ▶ The thread depth must be 3mm or deeper to mount the filter case with lens holder.

Outline Drawing

LHGC-10/15

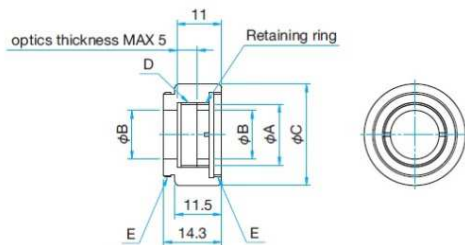

Part Number	φA (mm)	φB (mm)	φC (mm)	D	E
LHGC-10	φ10 ^{+0.03} _{-0.02}	φ7	φ17.5	M10.85×0.75	M13.55×0.75
LHGC-15	φ15 ^{+0.03} _{-0.02}	φ12	φ25	M15.85×0.75	M20.85×0.75

LHGC-12.7/20/25.4/30/50.8

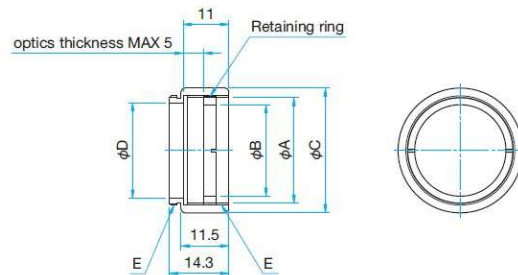

Part Number	φA (mm)	φB (mm)	φC (mm)	φD (mm)	E
LHGC-12.7	φ12.7 ^{+0.03} _{-0.02}	φ10	φ17.5	φ11.5	M13.55×0.75
LHGC-20	φ20 ^{+0.03} _{-0.02}	φ17	φ25	φ17.5	M20.85×0.75
LHGC-25.4	φ25.4 ^{+0.03} _{-0.02}	φ22	φ30	φ23	M26.25×0.75
LHGC-30	φ30 ^{+0.03} _{-0.02}	φ27	φ35.5	φ27	M30.85×0.75
LHGC-50.8	φ50.8 ^{+0.03} _{-0.02}	φ47	φ55.5	φ47	M51.65×0.75

Specifications

Primary material: Aluminum
Finish: Black Anodized

Part Number	Compatible Optics		Clear Aperture φB [mm]	Weight [kg]
	Diameter [mm]	Thickness [mm]		
LHGC-10	φ 10	- 5	φ 7	0.006
LHGC-12.7	φ 12.7	- 5	φ 10	0.006
LHGC-15	φ 15	- 5	φ 12	0.011
LHGC-20	φ 20	- 5	φ 17	0.007
LHGC-25.4	φ 25.4	- 5	φ 22	0.008
LHGC-30	φ 30	- 5	φ 27	0.012
LHGC-50.8	φ 50.8	- 5	φ 47	0.018



Tokyo Head Office
5F, SIGMA KOKI Tokyo Head office 1-19-9,
Midori, Sumida-ku, Tokyo, 130-0021, JAPAN
TEL. +81-3-5638-8228
FAX. +81-3-5638-6550
E-mail international@sigma-koki.com

Osaka Branch
4-9-28 Nishi-Nakajima,
Yodogawa-ku, Osaka 532-0011
TEL. +81-6-6307-4835
FAX. +81-6-6307-4834
E-mail sales.osaka@sigma-koki.com

Kyushu Sales Office
3-17 Hie-machi, Hakata-ku, Fukuoka 812-0014
TEL. +81-92-481-4300
FAX. +81-92-481-4310
E-mail sales.kyushu@sigma-koki.com