

Square Plate Holders Camera Holders

KMH
CMH

KMH

RoHS Catalog Code W4047

Holders for square plates such as flare plates (BBP), test targets and square filters.

- Designed to gently hold glass plates, the holder include a soft cork lined back plate and resin tipped clamping screws.



Specifications					Primary material: Aluminum Finish: Black Anodized
Part Number	Options specified*	Compatible Optics Dimensions [mm]	Compatible Optics Thickness [mm]	Weight [kg]	
KMH-30	N/EE/UU	□10 – □45	3 – 5	0.08	
KMH-80	N/EE/UU	□45 – □100	1 – 7	0.11	
KMH-150	N	□100 – □180	6 – 17	0.38	

* For specifying options, please refer to "Conversion of Posts, Post Holders and Pedestal Bases of Holders". [Reference](#) C007

Guide

- Use the sliding cylindrical lens holder (CHA) to hold rectangular lenses. [Reference](#) C048
- Post length can be changed by specifying the post length when you place an order. We may charge the difference in price depending on the length. Contact our Sales Division for more information.

Attention

- Glass can break if screws are over tightened.

Outline Drawing

KMH

M6 P1

2D CAD 3D CAD

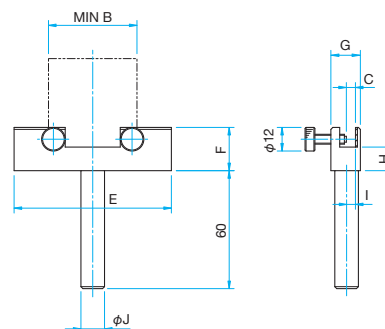

Part Number	MIN B (mm)	MAX C (mm)	MIN C (mm)	E (mm)	F (mm)	G (mm)	H (mm)	I (mm)	φJ (mm)
KMH-30	10	5	3	30	15	12	10	3.5	φ12
KMH-80	45	7	1	80	22	15	12.5	4.5	φ12
KMH-150	100	17	6	150	30	30	15	10.5	φ20

CMH

RoHS Catalog Code W4104

Post mounted ball head camera mount. Allows cameras with standard 1/4-20 mounting holes to be used on an optical breadboard.

- Loosen the clamp to freely position the camera, and tighten the clamp to lock in place.
- These platforms can mount any camera because they use the mounting screw standard commonly used for cameras.
- Posts with 1/4-20 screws can be directly attached to cameras for applications where tilt adjustment is not needed.

[WEB Reference](#) [Catalog Code](#) W6052



Specifications				Primary material: Aluminum Finish: Black Anodized
Part Number	Options specified*	MAX Load Capacity [N]	Weight [kg]	
CMH-1	N	29.5 (about 3kgf)	0.17	
CMH-2	N	40 (about 4kgf)	0.34	

* For specifying options, please refer to "Conversion of Posts, Post Holders and Pedestal Bases of Holders". [Reference](#) C007

Outline Drawing

CMH-1

1/4-20UNC (inch male thread)

CMH-2

1/4-20UNC (inch male thread)

2D CAD 3D CAD

